



2 Vine Cottages, Handley Street, Ebbesbourne Wake, Salisbury, Wiltshire, SP5 5JG

£1,150 PCM

A charming 2 bedroom, extended semi-detached thatched cottage in the centre of this popular Chalke Valley village. The accommodation comprises: an entrance lobby/utility area, cloakroom/wc, kitchen/breakfast room with electric oven, ceramic hob, integral dishwasher and a full range of fitted units with down lighting, The AGA shown in the photos is non functioning. Living room with vaulted ceiling and french doors to garden. Two double bedrooms and bathroom with electric shower over bath. Enclosed rear garden, mainly grass with terrace, shed and lovely views towards chalk downland beyond. Graveled parking for several cars. New electric heating, Unfurnished with relatively new carpets and decorartion.

Ground Floor

Approx. 86.2 sq. metres (928.2 sq. feet)

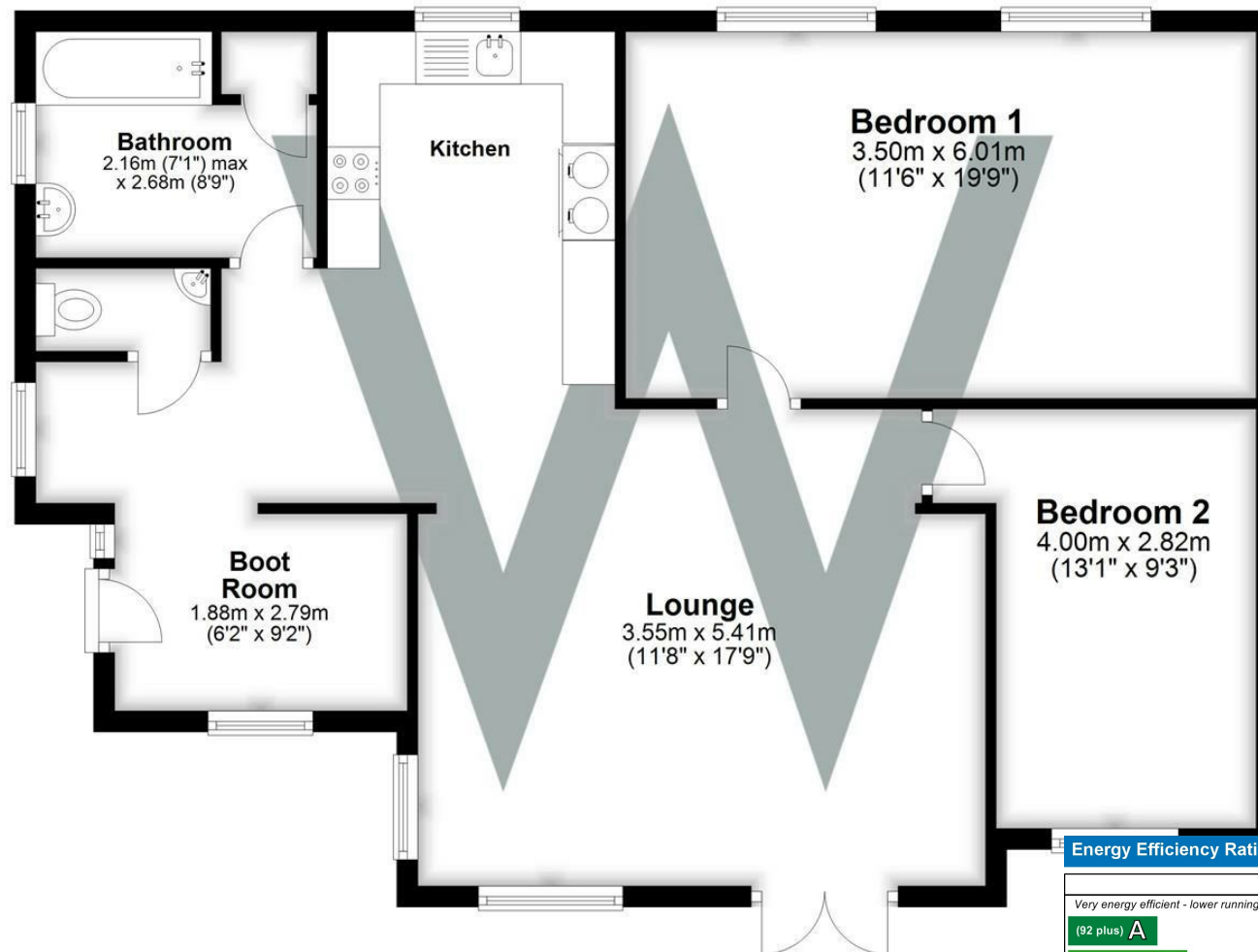

Total area: approx. 86.2 sq. metres (928.2 sq. feet)

Energy Efficiency Rating

Very energy efficient - lower running costs	Current	Potential
(92 plus) A		88
(81-91) B		
(69-80) C		
(55-68) D	55	
(39-54) E		
(21-38) F		
(1-20) G		
Not energy efficient - higher running costs		
England & Wales	EU Directive 2002/91/EC	



WHITES

Castle Chambers, 47 Castle Street,
Salisbury, Wiltshire, SP1 3SP

01722 336422

www.hwwhite.co.uk

residential-sales@hwwhite.co.uk

